

N = Number of poles
 Dim L = N x 5.0
 Dim P = (N - 1) x 5.0

	Dim L	Dim P
2-6p	±0.15	±0.10
7-12p	±0.20	±0.20
13-18p	±0.30	±0.25
19-24p	±0.40	±0.30

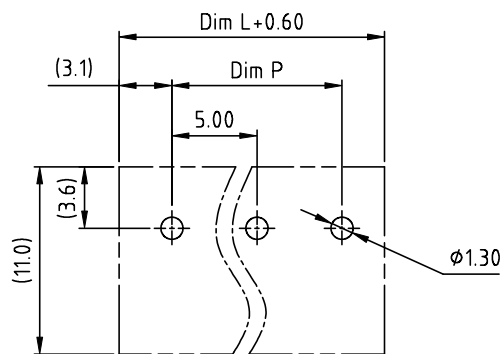
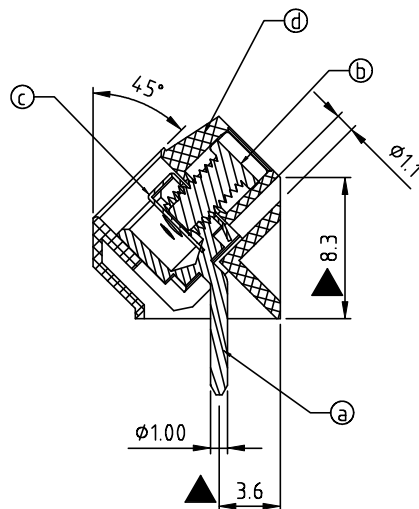
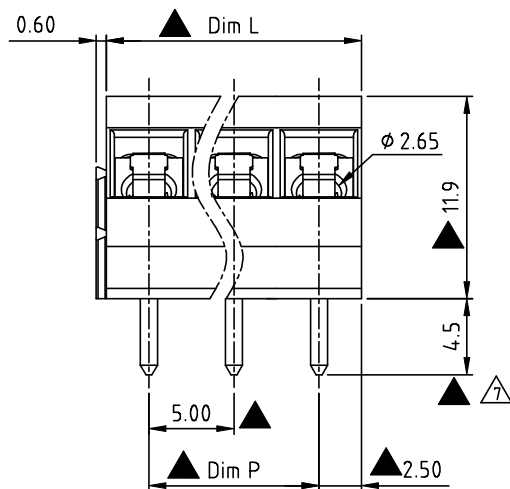

RECOMMENDED PCB LAYOUT

REV.	SIGN	DATE	DESCRIPTION	APPROVER
A	△	2/8'06	Part No.changed	Tony
B	△	02/01'07	Part No.changed	Marivn
C	△	12/16'08	hole form change	Tony
D	△	04/23'10	Add the tolerance table	Tason
E	△	04/23'10	Operating tem. changed from -45°C +130°C to -40°C +130°C	Tason
F	△	04/23'10	Soldering tem. changed from 260°C to 280°C	Tason
G	△	03/05'12	The dimension is changed from 4.8mm to 4.5mm	Chen Bo
H	△	03/21'17	changed material PA46 to PA4T and electrical specification	Johnson
THIS IS CAD DRAWING, DO NOT REVISE MANUALLY!!!				

Material

- Item ③ Terminal body(metal housing): Brass(CuZn), Tin plated
- Item ⑤ Terminal screw: Steel Zinc plating "-" slot type
- Item ⑦ Wire guard: Stainless steel
- △ Item ④ Insulator (housing): PA4T 30%GF (UL94 V-0)

Electrical

- Voltage rating: 300VAC
- Current rating: 15A
- Wire range:
- Solid wire(AWG): 14-22
- Stranded wire(AWG): 14-22
- Torque(Lb-In): 3.5
- Screw: M2.6
- Wire strip length: 6-7mm
- Withstanding Voltage: 1.6KV
- Operating temperature: -40°C to +130°C
- △ Item ⑤ ● Reflow temperature: 260°C/10 Sec
- △ Item ⑥ ● Critical dimension: △

△ Part No.: VY xx 01 0 C xxxx G

02 2 POLES	Color	0000: "@" Logo	G RoHS compliant
03 3 POLES	0 Black (RAL9005)	000A: "ANYTEK" Logo	(lead<4%)
...		00PM: "PM" Logo	In copper Alloy
24 24 POLES		Any special item by customer request. please contact sales department.	

Amphenol
ANYTEK

CUSTOMER COPY

ALL RIGHTS RESERVED. REPRODUCTION OR ISSUE TO THIRD PARTIES IN ANY FORM WHATEVER IS NOT PERMITTED WITHOUT WRITTEN AUTHORITY FROM THE PROPRIETOR. PROPERTY OF ANYTEK TECHNOLOGY CO., LTD

TITLE	VY-5.0mm Series HI-Temp type			
PART NO.	VYxx010CxxxxG			DWG NO. 8VY0001
APPROVED	CHECKED	DESIGNED	DRAWN	CUST NO.
		Johnson 2017.03.21	Johnson 2017.03.21	
SHEET: 01/01				UNIT: mm SCALE: NONE REV.: H
				Tolerance X. ±0.50 X.X ±0.30 X.XX ±0.10 X° ±1°