

RoHS Compliant

REV	SIGN	DATE	DESCRIPTION	APPROVER
A0		2023.09.15	Initial Release	

THIS IS CAD DRAWING, DO NOT REVISE MANUALLY!!!

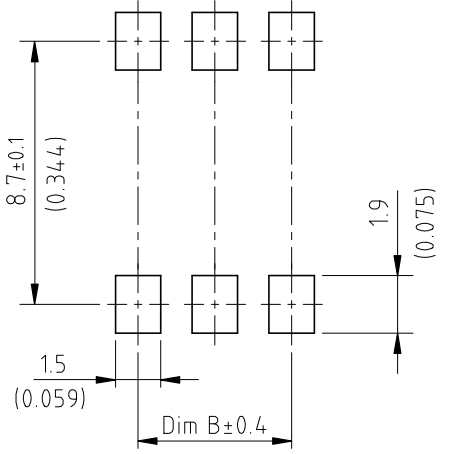
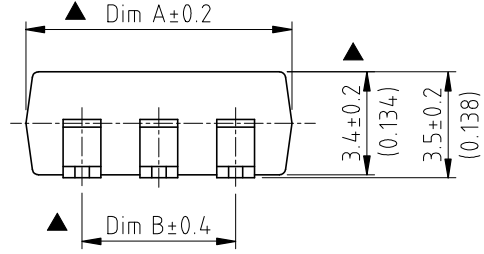
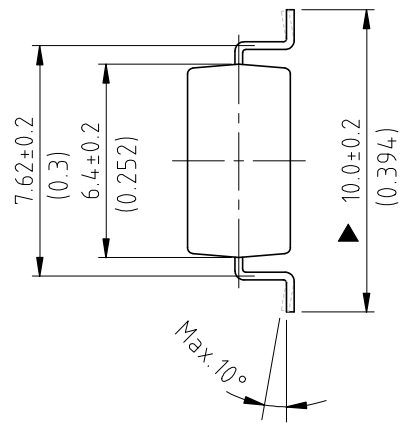
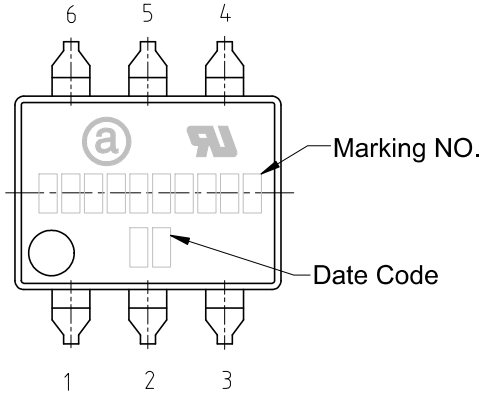

P.C.B. LAYOUT
Top View

$$\text{Dim B} = 2.54 \times ((\text{Pin}/2) - 1)$$

$$(0.100 \times ((\text{Pin}/2) - 1))$$

Pin out	Dim A	Dim B
4 Pin	4.7(0.185)	2.54(0.100)
6 Pin	8.8(0.346)	5.08(0.200)
8 Pin	9.78(0.385)	7.62(0.300)

Part No. APR 3 x xx xx x x 00 Ex0G

- RoHS compliant
- Any special item by customer request, please contact sales department.
- Packing type:
0 : IC Tube, 1 : Tape & Reel,
- Pin number:
4 : 4pin, 6 : 6pin, 8 : 8pin,
- Load voltage:
03: 30V, 04: 40V, 06: 60V, 08: 80V, 10: 100V, 20: 200V,
25: 250V, 35: 350V, 40: 400V, 60: 600V, F0: 1500V,
- Contact type:
1A : 1 Form A 1B : 1 Form B 1C : 1 Form A & 1 Form B
2A : 2 Form A 2B : 2 Form B
- Load type,
0: DC 1: AC&DC
- Mounting type:
3: SMD
- Series name : APR: MOS RELAY

Mark No. APR x xx xx x x

- Special Number
- Mounting & Load type:
T: Through hole, M: SMD type, S: SOP type
F: DC output & through hole
N: DC output & SMD, K: DC output & SOP
- Load voltage:
03: 30V, 04: 40V, 06: 60V, 08: 80V, 10: 100V, 20: 200V,
25: 250V, 35: 350V, 40: 400V, 60: 600V, F0: 1500V,
- Contact type:
1A : 1 Form A 1B : 1 Form B 1C : 1 Form A & 1 Form B
2A : 2 Form A 2B : 2 Form B
- Pin number:
4 : 4pin, 6 : 6pin, 8 : 8pin,
- Series name : APR

* 4Pin product printing content don't have "APR" characters
4Pin 产品印字内容无APR字符

Amphenol ANYTEK				CUSTOMER COPY		
ALL RIGHTS RESERVED. REPRODUCTION OR ISSUE TO THIRD PARTIES IN ANY FORM WHATSOEVER IS NOT PERMITTED WITHOUT WRITTEN AUTHORITY FROM THE PROPRIETOR PROPERTY OF ANYTEK TECHNOLOGY CO., LTD						
TITLE	APR Series Relay, SMD type					
PART NO.	APR 3 x xx xx x x 00 Ex0G			DWG NO.	8APR002	
APPROVED	CHECKED	DESIGNED	DRAWN	CUST NO.	Tolerance	
		Lena 2023.09.15	Lena 2023.09.15		UNIT: mm	X. ±0.50
					SCALE: 4:1	X.X ±0.30
					REV.: A0	X.XX ±0.20
				SHEET: 01/01	X° ±1°	